

DATA SHEET

**MANUAL GAS DISCHARGE STATION WITH HOLDING,
SUPERVISING & INDICATION FOR OUTDOOR APPLICATION**

PART NO :
IH029/1 HSI

FIRST ISSUE DWG. NO:DP-5.8/08-127	DATE :10th OCT.2009	SCALE : N.T.S	SHEET : 1 OF 1	APPD. BY :D.B
LATEST ISSUE DOC.NO:DP-5.8/MT-093	DATE :03rd AUG.2020			

INTRODUCTION :-

MANUAL GAS DISCHARGE STATION IS USED IN GAS BASED FIRE EXTINGUISHING SYSTEM FOR SEMI OUTDOOR APPLICATION. BY OPERATING DISCHARGE STATION, EXTINGUISHING GAS CAN BE DISCHARGED MANUALLY. INDICATION IN MANUAL GAS DISCHARGE STATION WILL CONFIRM THE OPERATION. THE DEVICE HAS INBUILT HOLDING CIRCUIT. THIS DEVICE IS SPECIALLY DESIGNED TO CONNECT WITH IH046 SERIES TYPE III & TYPE IV CONVENTIONAL FIRE DETECTION AND DISCHARGE PANEL.

NOTE: THIS DATASHEET CAN BE ALSO REFERRED AS DOC. NO: DP-5.8/CP-093

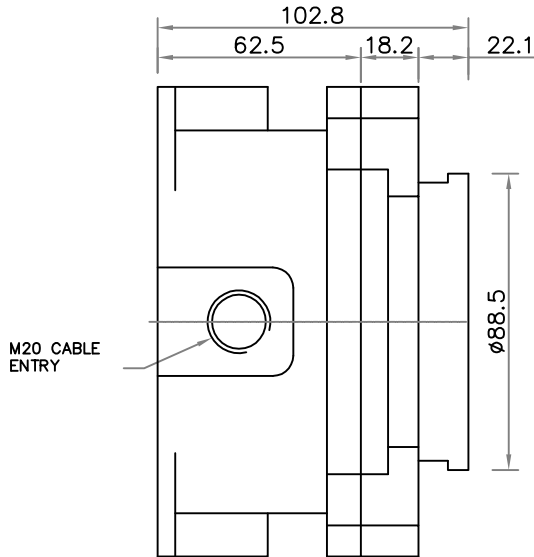

SIDE VIEW

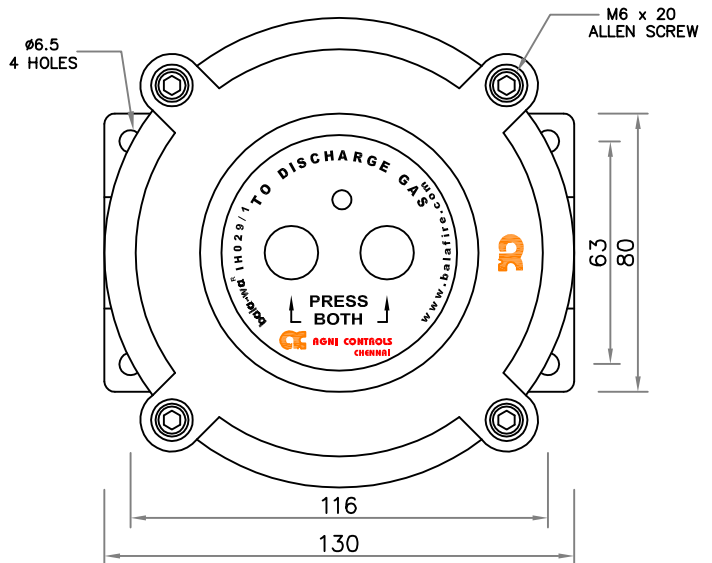

ELEVATION

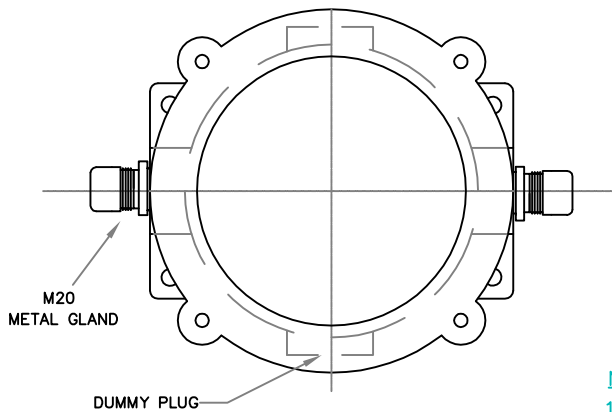

FRONT VIEW

TERMINAL DETAIL

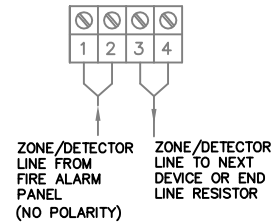

NOTE:

1. ALL DIMENSIONS ARE IN "mm" UNLESS OTHERWISE SPECIFIED.
2. TOLERANCE ON DIMENSION ± 3 MM, UNLESS OTHERWISE SPECIFIED.

TECHNICAL SPECIFICATION

01. MANUFACTURER	AGNI CONTROLS – CHENNAI	06. TYPE OF MOUNTING	WALL MOUNTING
02. CONSTRUCTION	CAST ALUMINIUM LM6	07. INPUT SUPPLY	DETECTOR LINE OR ZONE LINE
03. COLOUR	TEXTURED FIRE RED (POWDER COATED)		FROM STANDARD CONVENTIONAL
04. FASTENERS	SS 304		FIRE ALARM PANEL.(IH046 SERIES
05. CABLE ENTRY	M20X1.5 – 3 Nos.		TYPE III & TYPE IV)

IMPORTANT:

AGNI CONTROLS RESERVES THE RIGHT TO CHANGE OR MODIFY WITHOUT PREVIOUS NOTICE ANY DATA OR SPECIFICATION DUE TO CHANGES OR MODIFICATION IN ORDER TO IMPROVE THE PRODUCTS / SYSTEM PRESENTED.



**AGNI CONTROLS
CHENNAI**

**ISO 9001 - 2015
CERTIFIED COMPANY**

NO.1, 6TH STREET, Dr.SUBBARAYAN NAGAR,
KODAMBAKKAM, CHENNAI-600 024, INDIA.
PHONE : +91 44 2481 2420
E-MAIL : engineering@agnicontrols.com WEBSITE : www.balafire.com